

## CONTACTS

unitechnic.cz s.r.o.  
Reklamační a servisní oddělení  
Areál bývalého cukrovaru  
Hlavní 29 (hala č.3 uni-max)  
277 45 Úžice

Tel. reklamačního odd.

266 190 156

T-Mobile 603 414 975

266 190 111

O2 601 218 255

Fax 266 190 100

Vodafone 608 227 255

E-Mail: <http://www.uni-max.cz>  
[reklamace1@khnet.cz](mailto:reklamace1@khnet.cz)  
[obchod@khnet.cz](mailto:obchod@khnet.cz)

# uni-max

## USER'S MANUAL

## CIRCLE HOLE SAW 200 MM WITH COVER - SET



### QSK200



## DISPOSAL

It is necessary to dispose of the product at the end of its service life in accordance with the applicable legislation. The product is made of metal and plastic parts that are recycled separately after being sorted.

1. Disassemble all parts of the equipment.
  2. Sort all parts according to the material (metals, rubber, plastics, etc.).
- Hand over the sorted material for further use.

Information on collection points is available at your local city office or on the internet.

## ATTENTION

In the event of a malfunction, send the equipment to the vendor's address so that the repair can be carried out as soon as possible. A brief description of the fault will shorten troubleshooting and repair time. Include the warranty card and proof of purchase with the equipment within the warranty period. We will repair your equipment for a reasonable price after the warranty period expires.

To prevent damage to the equipment during transport, pack it securely and use the original packaging. We are not liable for any damage during transit and any claims with the shipping service depends on the level of packaging and protection against damage.

**Note:** The illustrations may differ from the delivered product and the scope and type of the supplied accessories may also vary. This is a result of development, and such differences have no impact on the product's correct functionality.

## SAFETY PRECAUTIONS

- **The equipment may only be operated by persons over 18 years of age, duly qualified, informed about and trained in the principles of safety and occupational health and safety.**

### Symbols used in these instructions



**Attention!**

Indicates a risk of injury or significant material damage.



**Risk of entanglement!**

Beware of injury caused by the entanglement of clothing or body parts by rotating parts.



**Warning!**

Risk of damage



**Note:**

Additional information



**General**

- Plastic bags for packaging can be hazardous to children and animals.
- Familiarize yourself with the equipment, its controls, operation, elements of this equipment and possible risks associated with its incorrect use.
- Ensure that the user of the equipment has been thoroughly familiarised with the controls, operation, elements of this equipment and possible hazards resulting from its use.
- Keep the workplace clean and in order. Untidiness in the workplace may lead to an accident.
- Never work in cramped or poorly lit areas. Always make sure that the floor is stable and there is good access for performing work tasks. Always maintain a stable posture.
- Continuously observe the workflow and use all your senses. Do not continue working if you cannot maintain full concentration.
- Take care of your tools and keep them clean.
- Handles and switches must be kept dry and free from oil and grease.
- Do not use the equipment for any purpose other than that for which it is intended.
- Use personal protective equipment during work (e.g. goggles, earmuffs, respirator, safety footwear, etc.).
- Do not overexert yourself, always use both hands.
- Never operate the equipment under the influence of alcohol and drugs.
- No modifications to the equipment are permitted. DO NOT USE it if you discover bent parts, cracks or other damage.

- Protect the equipment against excessive heat and sunlight.
- The equipment is not designed for work under water or in a wet environment.
- When not using the equipment, store it in a dry, safe place away from children.
- Before starting the equipment, check that all safety elements are working smoothly and efficiently. Make sure that all moving parts are in good condition.
- Check whether any parts are broken or stuck, make sure that all components are properly mounted. Also check all other conditions, which may affect the operation of the equipment.
- Unless otherwise stated in this manual, any damaged parts or safety elements must be repaired or replaced.

### Hand tools

- Do not put the tool aside until it has come to a complete stop.
- When putting the equipment aside, take care that it is not leaning on the bit/blade.
- Never clamp the tool into a vice.
- Keep the workpiece firmly secured in place and be extremely careful when handling or releasing it.

### Rotary tools

- Always wear suitable work clothing (e.g. do not wear loose clothing, ties, jewellery etc., tie up long hair behind the head, protect the feet and do not wear worn-out footwear. Shirt sleeves must be buttoned up or rolled up).  
Risk of getting caught or winding on to rotating parts.
- Do not remove safety covers and ensure that maximum protection is provided to the operator.
- Avoid coming into contact with moving parts during work. Keep hands away from rotating parts.

### Drilling

- Secure the material being drilled against rotation.
- Prior to turning on the equipment, make sure that the speed and rotation direction correspond to the set diameter of the equipment.

## OPERATION

- Set the distance between the blades using an Allen key (30 - 120 mm).
- Remove the nut (D) and the spring (C) from the circle hole cutting saw.
- Insert the circle hole cutting drill bit through the cover (A) and secure it in place using the spring (C) and nut (D).
- Clamp the top part of the circle hole cutting drill bit into an electric drill and drill out the hole.

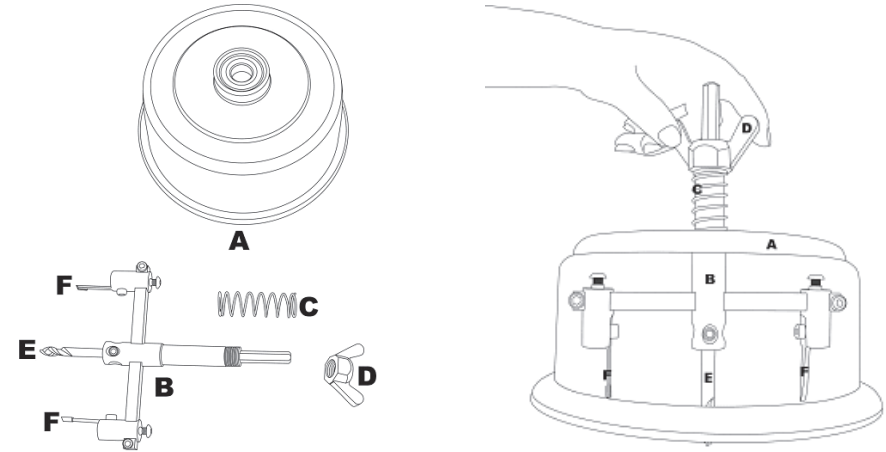

## MAINTENANCE

- Always keep tools clean.
- Do not use any aggressive cleaning agents and solvents for cleaning.
- We recommend wiping plastic parts with a rag dipped in soapy water.
- Wipe metal surfaces with a rag dipped in kerosene.
- Store the unused equipment in a preserved state in a dry place where it will not corrode.



A specific description of the work activity and application of the product is intentionally not mentioned, since the manufacturer / importer assumes that the user knows the function of the product and understands its activity, since in the sense of the law it is a common product. In the event that the user does not have this knowledge or is unsure, it is recommended that they contact the Workplace Safety Inspection Authority.